

RURAL MUNICIPALITY of EDENWOLD No. 158

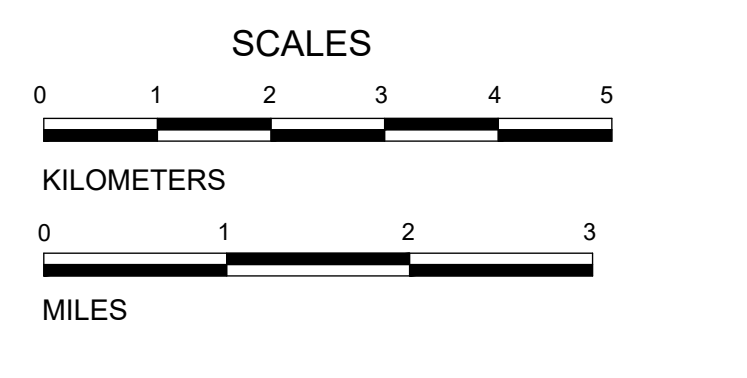

WEST OF THE SECOND MERIDIAN
 100 Hutchence Road
 Emerald Park, SK S4L 1C6
 Phone: (306) 771-2522
 Email: info@edenwold-sk.ca

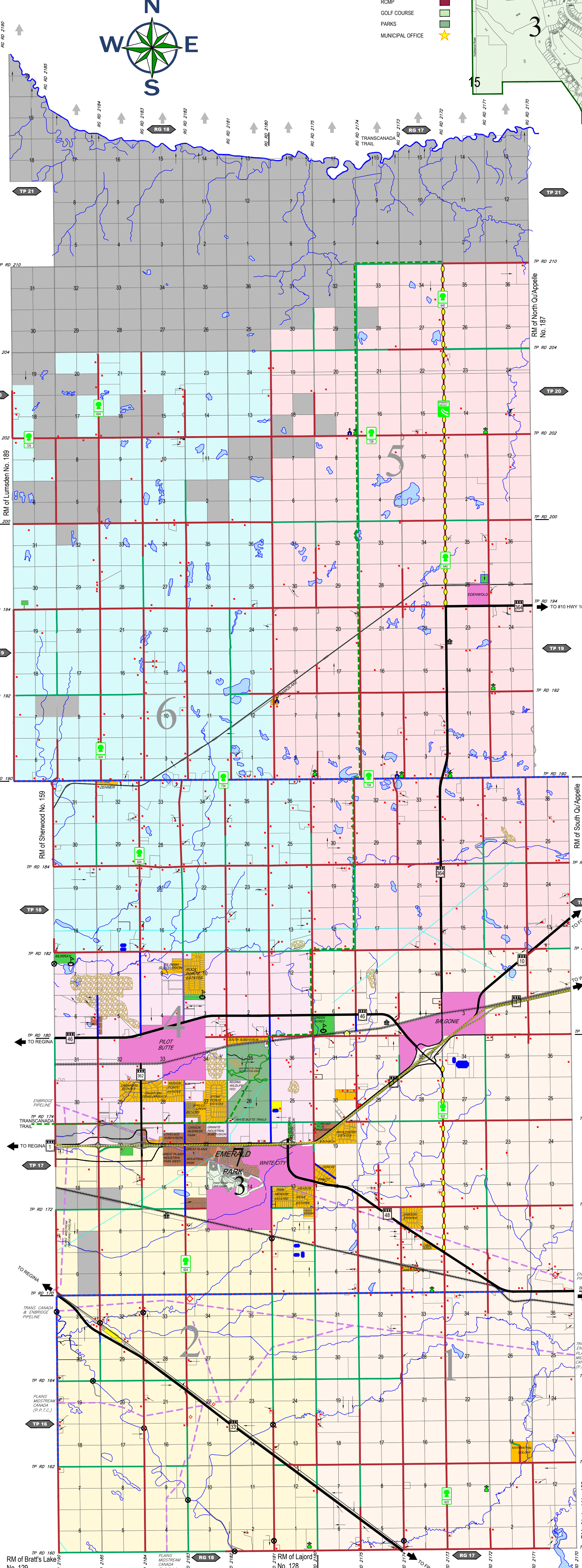
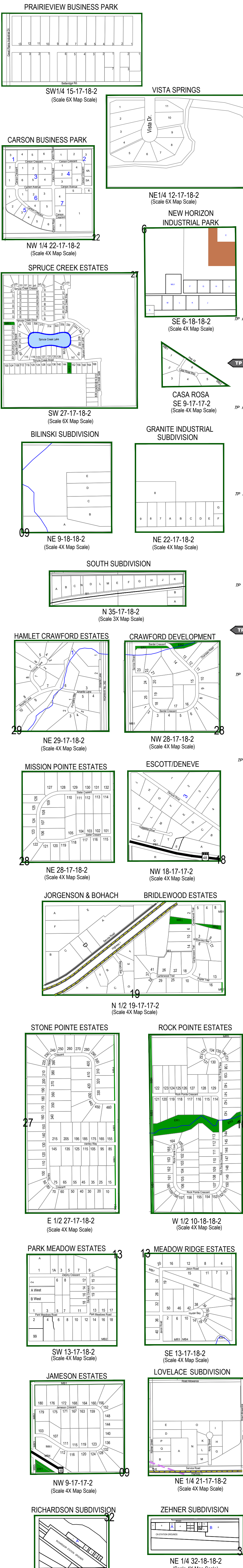
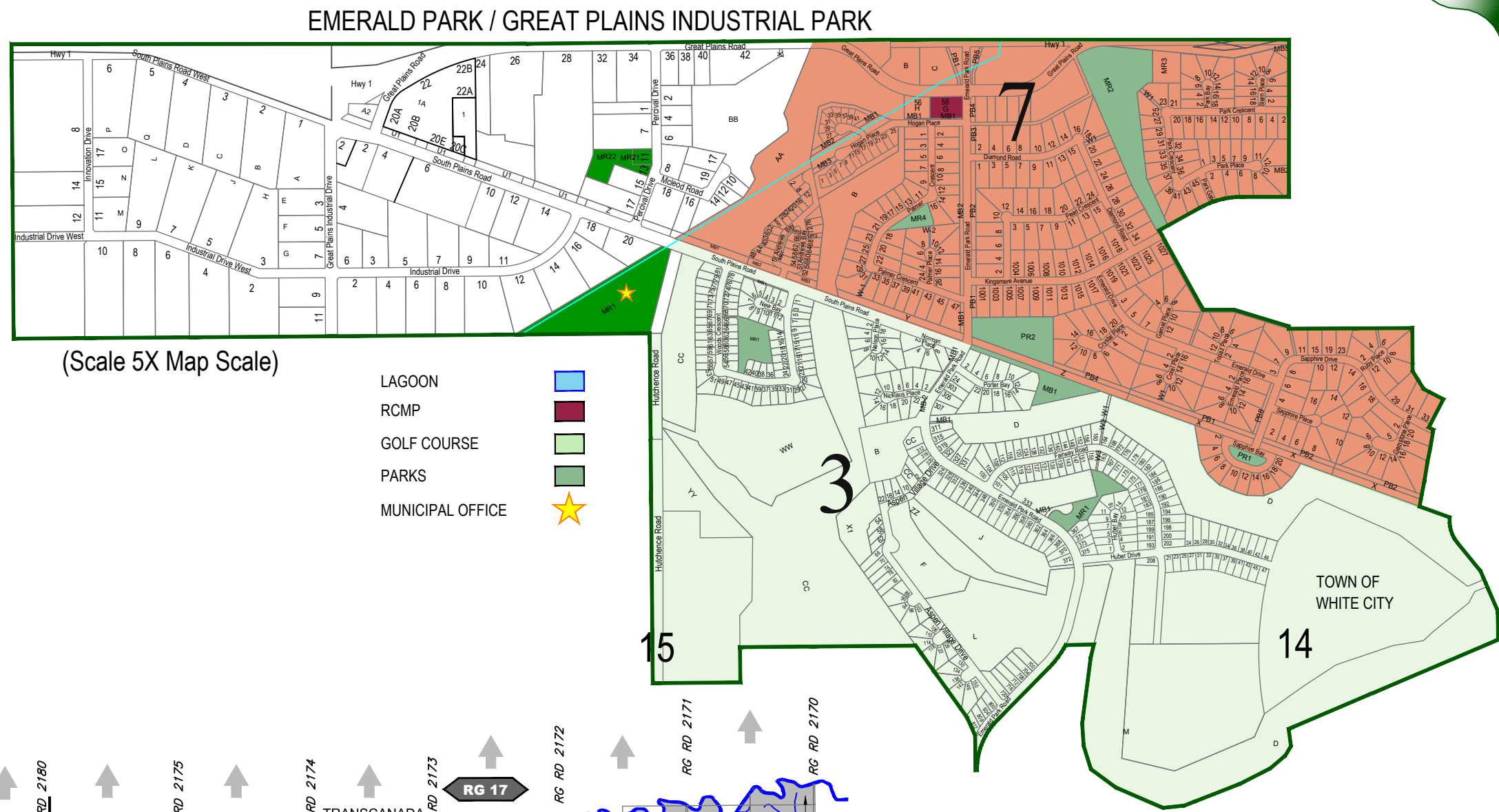

MUNICIPAL COUNCIL

DIVISION INDEX	REEVE	Trans: Alan
DIVISION 1	Councillor	Laibel, Glenn
DIVISION 2	Councillor	Caparhurst, Stan
DIVISION 3	Councillor	Powish, Nichole
DIVISION 4	Councillor	Kojik, Karen
DIVISION 5	Councillor	Wimmer, Stephen
DIVISION 6	Councillor	Brad, Tim
DIVISION 7	Councillor	Bedrovske, Darren

LEGEND

- Highway-2 Lane
- Highway-4 Lane
- CTP Road Primary
- Municipal Gravel
- Municipal Dirt
- Municipal Paved Primary
- Municipal Paved Secondary
- TransCanada Trail
- Overdimensional Route
- Unimproved
- Railway
- Pipelines
- Sask Power Transmission Line
- Church
- Cemetery
- Residence
- Bridge
- Tower
- Lake/Slough
- River/Creek
- Lagoon
- Gravel Pit
- Grain Terminal
- Municipal Office
- Mustard Plant
- Community Hall
- Golf Course
- Compressor/Pumping Station
- City, Town, Village
- First Nation Land
- Recreation Area

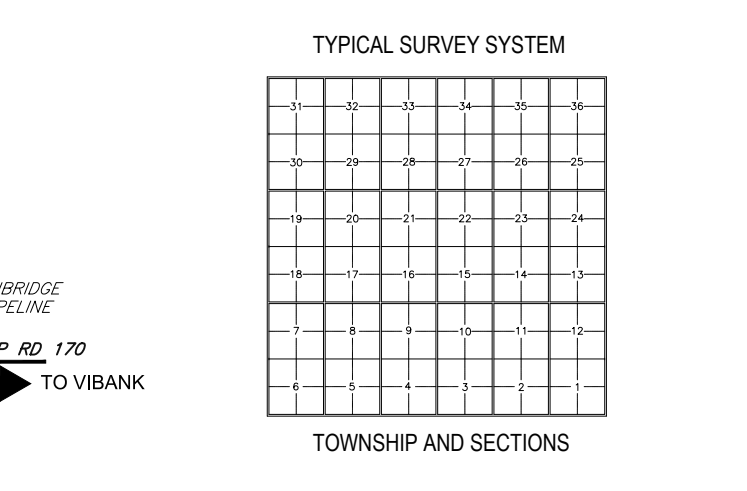
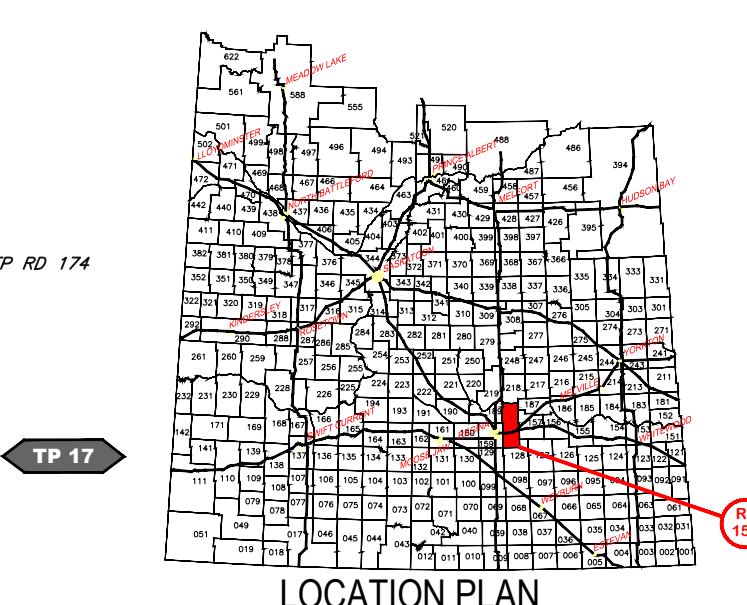

SECTION AND LSD'S

13	14	15	16
10	11	12	9
7	8	5	6
4	3	2	1

DISCLAIMER & COPYRIGHT NOTICE
 The production of this map remains the property of Prairie Mapping Industries and as such cannot be reproduced in any form, including digitally, without the written permission from Prairie Mapping Industries. Unauthorized reproduction or use in part or in whole is strictly prohibited. The information shown on this map is obtained from various sources and Prairie Mapping Industries can not be responsible for any errors or omissions which may be present on this map. For errors or omissions please notify the office using the contact information found on the map.
 Roads are kept ploughed by the Municipality under normal winter conditions. No order of ploughing is implied. It is the responsibility of the user to determine accessibility before traveling on any road. Prairie Mapping Industries nor the Municipality assume any liability for any accidents which may occur because of road conditions.